



Automatic Tool Changer

ATC Unit for Vertical Machining Centers
TCU30, 40, 50 (#30, #40, #50)

Features

Total ATC units shipped: 70,000

- **Excellent Productivity**
Tool to Tool 0.94~1.2sec (TCU40)
High-speed tool change operation drastically reduces machining time.
Tool to tool: 0.94 to 1.2sec (TCU40)
- **Reliability**
Widely used by many machine tool manufacturers.
- **Durability**
Exclusive cam mechanism offers long life.
- **Economic Advantage**
Reduces running costs without maintenance.



Common Specifications

Model Lineup	TCU30	TCU40	TCU50
Taper size	30	40	50
Holder type	BT/DIN/CAT/HSK (#30) Select one: BT, DIN, CAT, or HSK (excluding #30)		
Pull bolt	ISO/MAS Select one: ISO or MAS		
Arm format	Double arm		
Maximum tool weight	MAX5kg (Av3kg)	MAX7kg (Av5kg)	MAX15kg (Av8kg)
Maximum tool diameter (empty pockets on both sides)	φ80 (φ150)	φ80 (φ150)	φ127 (φ150)
Maximum tool length	300mm	300mm	300mm
ATC swing angle	75°, 180°	65°, 180°	90°, 180°
Tool changing time	0.8~1.1sec	0.94~1.2sec	1.94~3.2sec

Options

	Standard			Options		
	TCU30	TCU40	TCU50	TCU30	TCU40	TCU50
ATC drive source	Induction motor			Induction motor with brake or servomotor		
Magazine drive source	Cam (induction motor driven)			Servomotor		
Number of tools	20	24	24	16, 24	16, 20, 30, 40	20, 30
Double-arm length	370mm	530mm	600mm	310mm	500, 550, 600, 650mm	650, 700, 750, 900mm
Tool pots in magazine	Plastic			Steel		
Sensor	Photo-micro sensor			Proximity sensor, rotary encoder		

Outline Dimensions

Units:mm

TCU30

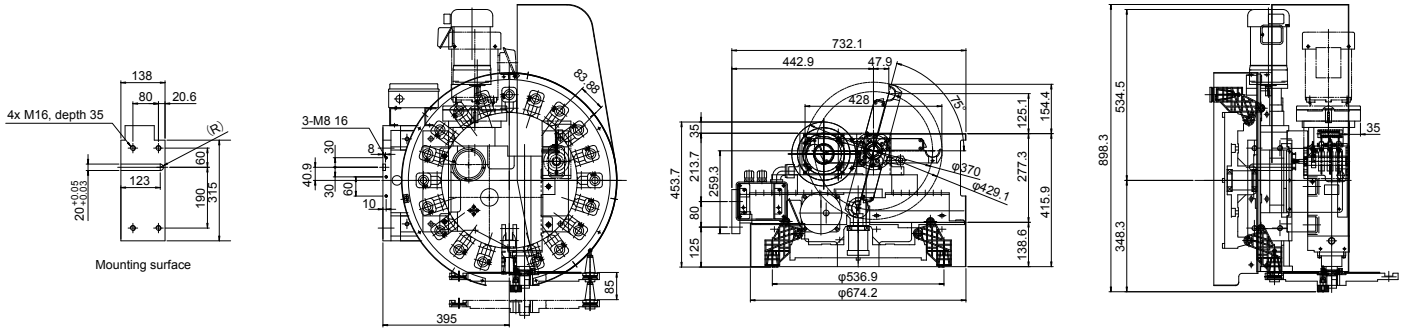

TCU40

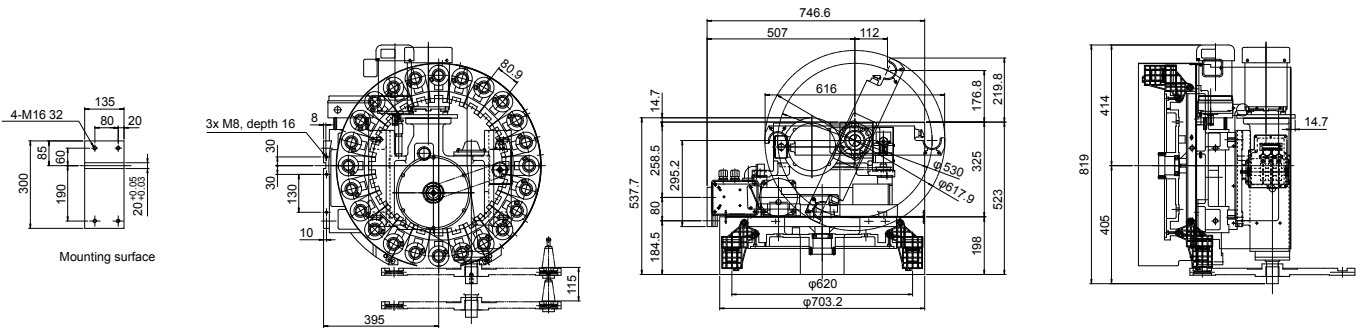

TCU50

